

Sepam series 80



Sepam series 80 is a family of **high performance digital protection relays**, for all public or industrial distribution network protection applications.

Characteristics

Conformity to standards

IEC 60255 - Protection relays	
IEC 60529 - Degree of protection	IP52 on front panel
IEC 60068 - Operating temperature	-25°C to +70°C (-13°F to +158°F)
IEC 61508 - Functional safety	SIL 2
IEC 61850-6, 7-1, 7-2, 7-3, 7-4 and 8-1	Communication networks and system in substation

Certifications

CE, UL508, CSA C22.2

Auxiliary power supply

24-250 V DC

Overall size of base units (H x W x D)

264 X 222 X 220 mm

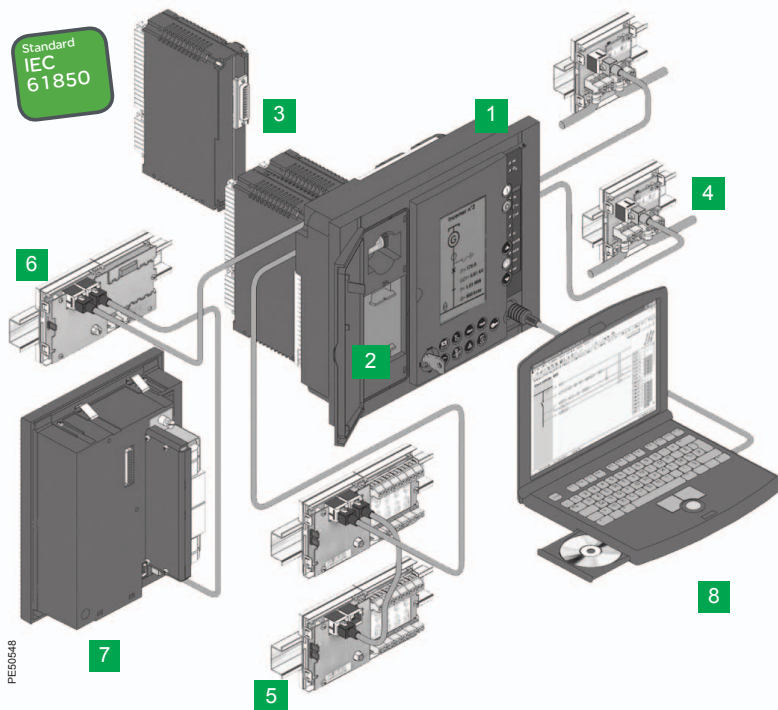

PE60548

Sepam series 80 and its optional modules

- 1 Base unit, with two types of User Machine Interfaces (UMI):**
 - Integrated mimic-based UMI
 - Integrated or remote advanced UMI
 - Front USB port for communication with setting software.
- 2 Parameters and protection settings saved on removable memory cartridge.**
- 3 42 logic inputs and 23 relay outputs, including 5 outputs on the base unit + 3 optional modules each providing 14 inputs and 6 outputs.**
- 4 2 independent communication ports:**
 - connection of each port to 1 or 2 S-LAN and/or E-LAN networks
 - Modbus, Modbus TCP/IP, IEC60870-5-103, DNP3 and IEC 61850 communication protocols
 - GOOSE messages and TCP/IP redundancy
 - RS485(2or 4 wire) or fiber optic network.
- 5 Temperature data from 16 sensors, Pt100, Ni100, or Ni120.**
- 6 1 analog output, 0-10mA, 4-20mA or 0-20mA.**
- 7 Synchro-check module**
- 8 Software tools:**
 - Sepam parameter and protection setting and control function customization
 - programming of specific functions (Logipam)
 - recovery and display of disturbance recording data
 - local or remote operation via an E-LAN.